

Waterproof Type

- SFJ series
- It is a small waterproofing foot switch for the medical equipment.
- Water-proof function is the highest class.
-Protection structure IP28.
- The wiping off of the dirt is easy by shaftless structure.
- Color to give an impression of cleanliness.
- Reliable design that can prevent malfunctions.

Three or more connections are also possible.
Please consult relevant business office.



SFJ-1W

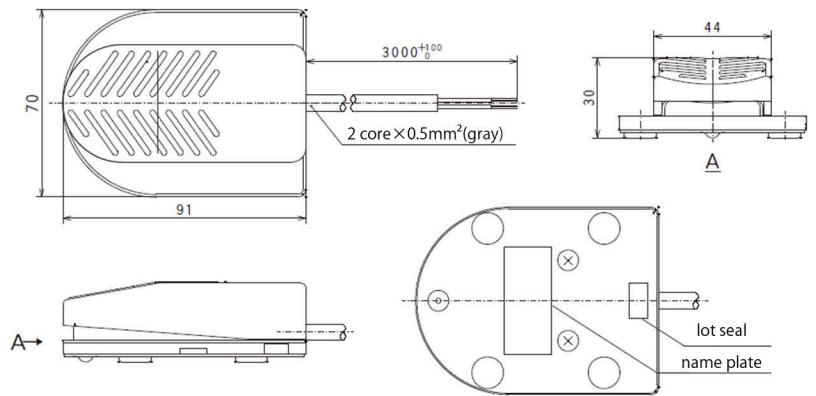

SFJ-1W-2

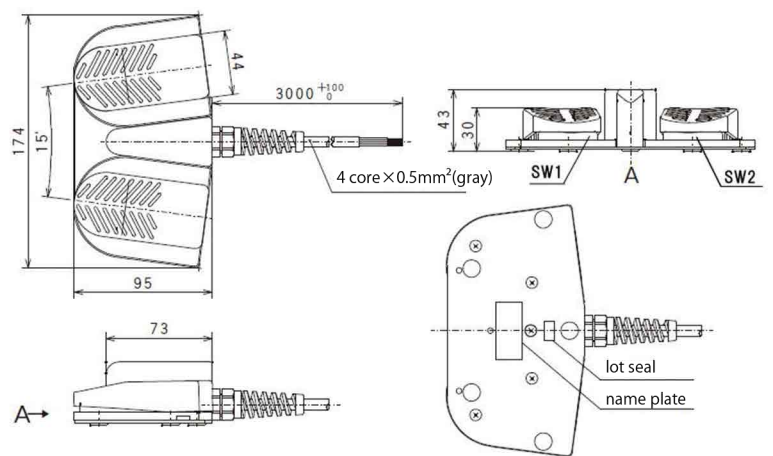

Major Parameters

Model	Rating	Contact Structure	Action	Insulation Rnbbcr Soft Wire	Action Force(N)	Built-in Switch	Weight(g)
			Instantaneous				
SFJ-1W	Standard rating: DC5~30V 100mA Feeble rating: DC6V 5mA DC12V 2mA DC24V 1mA	1a	●	CE UL 2 core×0.5mm ² ×3m (Gray)	about 11	Water proof V type micro switch IP 67	280
SFJ-1W-2		1a×2	●	CE UL 4 core×0.5mm ² ×3m (Gray)			530

Major Raw Materials

Model	Main Body / Protection Cover	Return Spring	Bottom Plate	Color/Paint Color
SFJ-1W	PBTresin	SUS(Stainless steel)	SUS304	Protection Cover : Green (equivalent to 5GB8/4*) Main Body : Gray (equivalent to N8*)
SFJ-1W-2				

[Universal Parameters]

- Insulation resistance / over 50MΩ
- Voltage withstanding / AC1500V / min
- Enbient btemperature: -5~40° (elevation 2000m or less)
Keep away from condensation.
- Embient relative humidity / 85%RH
- Static load strength / about 10KN/min
- Cable tensile force / about 88.2N/15sec

*Refr to R version standard color card publish by Japan Paint Manufacturers Association.