

SOCKET WRENCH

For manual

12.7

Improved work efficiency by using a socket holder (aluminum type) that allows easy removal.



HDB412

※ Socket holder is available for separate purchase. Please see P202 for details.

SOCKET SET (12pt.), with SOCKET HOLDER

Models **HDB412**

Contents **12 Items**

Descriptions	Models/The specification (inch)
SOCKET (12pt.)	4DB- 12(3/8), 14(7/16), 16(1/2), 18(9/16), 19(19/32), 20(5/8), 22(11/16), 24(3/4), 25(25/32), 26(13/16), 28(7/8), 30(15/16)

- SH1412 with socket holder (12 items type)
- Package size : w416 x d121 x h37mm
- Weight : 0.97kg
- Qty./Carton : 1



SOCKET (12pt.)

Models	Across Flat		Dimensions (mm)					Qty./Carton		Weight (g)
	(inch)	(mm)	D ₁	D ₂	L ₁	L	d	(Generally)	(Store Center)	
4DB-10	5/16	7.9	12.3	22.0	9	35.0	7	10	6	40
4DB-11	11/32	8.7	13.5	22.0	9	35.0	7	10	6	45
4DB-12	3/8	9.5	14.1	22.0	9	35.0	8	10	6	50
4DB-14	7/16	11.1	16.2	22.0	10	35.0	9	10	6	50
4DB-16	1/2	12.7	18.5	22.0	10	35.0	11	10	6	50
4DB-18	9/16	14.2	20.6	22.0	12	35.0	11	10	6	50
4DB-19	19/32	15.0	22.0	21.5	12	35.0	11	10	6	65
4DB-20	5/8	15.8	23.0	22.0	12	36.0	14	10	6	65
4DB-22	11/16	17.4	24.0	23.0	13	37.0	14	10	6	65
4DB-24	3/4	19.0	26.0	24.0	14	38.0	16	10	6	70
4DB-25	25/32	19.8	28.0	25.0	14	38.0	16	10	6	90
4DB-26	13/16	20.6	29.0	25.0	15	39.0	18	10	6	95
4DB-28	7/8	22.2	30.0	26.0	15	40.0	18	10	6	105
4DB-30	15/16	23.8	33.0	28.0	17	41.0	20	10	6	130
4DB-32	1	25.4	34.0	28.0	19	43.5	22	10	6	130
4DB-34	1-1/16	26.9	36.0	29.0	19	43.5	22	10	6	145
4DB-36	1-1/8	28.5	39.0	31.0	19	43.5	22	10	6	160
4DB-38	1-3/16	30.1	40.0	32.0	21	47.0	25	10	6	200
4DB-40	1-1/4	31.7	43.0	34.5	21	47.0	25	10	6	200

※ Inch/mm conversion chart is available in P489.



4DB-12



4DB-40

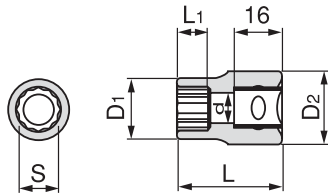

For Sq. bolt & nut



For Sq. bolt & nut



4E-17



4E-30

Square bolt nut

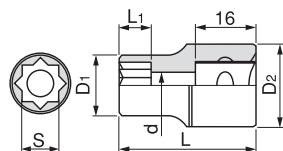

DUAL SQUARE SOCKET (8pt.)

Models	Across Flat (mm)	Dimensions (mm)					Qty./Carton (Generally)	Weight (g)
	S	D ₁	D ₂	L ₁	L	d		
4E-14	14	24	23.0	12	36.0	11	10	70
4E-17	17	29	25.0	13	37.0	14	10	100
4E-19	19	32	27.0	14	39.0	16	10	130
4E-21	21	35	28.0	15	39.5	18	10	140
4E-22	22	36	29.0	15	39.5	18	10	150
4E-23	23	37	30.0	16	40.5	20	10	155
4E-24	24	39	31.0	17	43.0	21	10	195
4E-27	27	43	34.5	19	45.0	22	10	245
4E-30	30	48	38.0	21	49.0	25	5	335
4E-32	32	51	43.0	21	55.0	25	5	470
4E-36	36	57	44.0	24	60.0	29	5	585

- for Sq. bolt & nut

