

FLEX CROW FOOT WRENCH

Models	Across Flat (mm)	Dimensions (mm)					Qty./Carton		Weight (g)
	S	D	A	T	L	L ₁	(Generally)	(Store Center)	
4DCF-22F	22	37.0	19.0	14.5	84	38.0	5	6	240
4DCF-24F	24	40.5	21.0	14.5	86	39.0	5	6	250
4DCF-26F	26	42.5	23.0	15.0	88	40.0	5	6	250
4DCF-27F	27	42.5	23.5	15.0	89	40.5	5	6	250
4DCF-29F	29	48.0	25.5	15.0	92	42.0	5	6	270
4DCF-30F	30	50.0	26.5	15.0	94	43.0	5	6	280
4DCF-32F	32	53.0	28.0	15.0	97	45.5	5	6	300
4DCF-36F	36	59.0	31.5	15.0	105	50.0	5	6	340

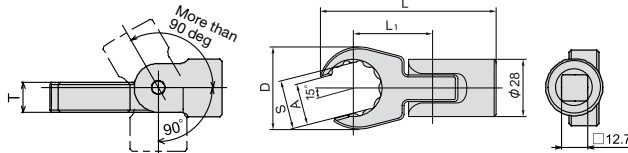

Example

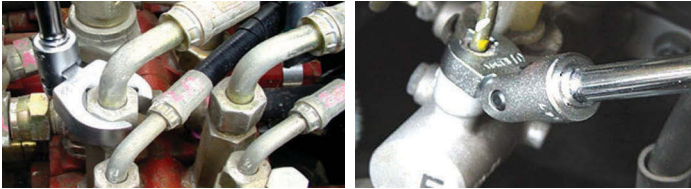

First 'Flexible Crow foot wrench' in the world!
Can set the angle of neck freely.
Ideal for tightening and loosening of pipings and sensors that used in air conditioner, hydraulic equipment and automobile.
Mouth is widened for easier use.



4DCF-24F



4DCF-36F



4P-20.8

PLUG SOCKET (6pt. with MAGNET)

Models 4P-16, 4P-18, 4P-20.8

Turn to P389 for more information.



For hand tool

CAUTION

• Do not use with power tools.