

## SPEED T-HANDLE

Models	Square Drive (mm)	Dimensions (mm)			Qty./Carton		Weight (g)
		H	d	L	(Generally)	(Store Center)	
303	12.7	190	12.7	300	1	1	655

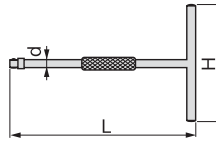

T-shaped handle with a square drive at its end. With special handle designed for quick turning. Convenient when exchanging various sizes of socket.

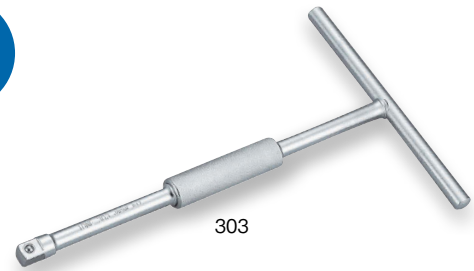

303

## T-TYPE HANDLE

Models	Square Drive (mm)	Dimensions (mm)				Qty./Carton		Weight (g)
		H	d <sub>1</sub>	d <sub>2</sub>	L	(Generally)	(Store Center)	
TH4300	12.7	220	12	16.5	300	5	5	460

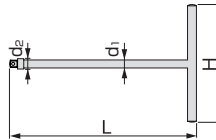

T-shaped handle with a square drive at its end. Convenient when exchanging various sizes of socket.

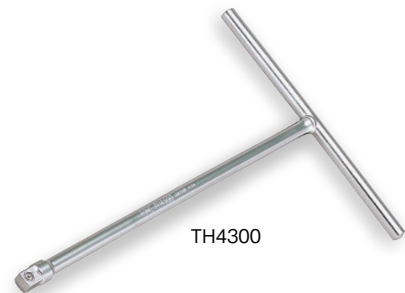

TH4300

## SPEED CROSS WRENCH

Models	Square Drive (mm)	Dimensions (mm)					Qty./Carton	Weight (g)
		D	D <sub>1</sub>	D <sub>2</sub>	L	H		
SCH40	12.7	14	25	22	129	400	2	810

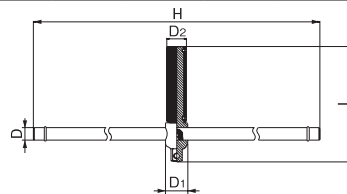

Switchable between T-shaped and L-shaped with a slide.



Detachable when removing O-ring, making it easy to put away when not in use.

Speed cross wrench for smooth and quick tightening work with replaceable tip.

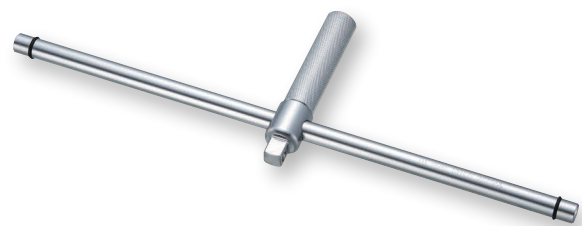

SCH40

Example



### CAUTION

- Do not abuse wrench, for instance, kick or lean on wrench.

### CAUTION

- Do not use with extension pipe etc.
- Insert square drive positively to the bottom.