

## BALL JOINT

Models	Square Drive (mm)	Dimensions (mm)				Qty./Carton		Weight (g)
		D <sub>1</sub>	D <sub>2</sub>	L <sub>1</sub>	L	(Generally)	(Store Center)	
<b>BJ40</b>	12.7	25	23.5	16	60	10	6	115

- Swing angle : About 30 degree



### CAUTION

- Joints consist of a convex drive and a concave drive and parts between them, and the torque. Do not handle the tool roughly as it might weaken torque transmission efficiency and impact torque. Both JIS and ISO standards are about half the strength of the ratchet handle.

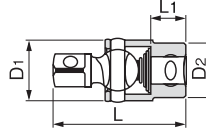

Ball joint is used on complicated place.

Rotates very smoothly as the ball-shaped joint refracts only one time.



BJ40

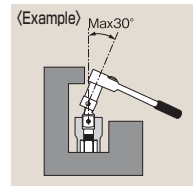

## UNIVERSAL JOINT

Models	Square Drive (mm)	Dimensions (mm)				Qty./Carton		Weight (g)
		D <sub>1</sub>	D <sub>2</sub>	L <sub>1</sub>	L	(Generally)	(Store Center)	
<b>UJ40</b>	12.7	25	25	15.5	60	10	6	126

- Swing angle : In left and right, 45 degree



### CAUTION

- Joints consist of a convex drive and a concave drive and parts between them, and the torque. Do not handle the tool roughly as it might weaken torque transmission efficiency and impact torque. Both JIS and ISO standards are about half the strength of the ratchet handle.

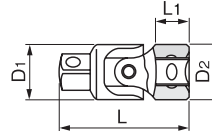

Universal joint, which is most suitable for working on limited space.

Connecting it between a handle and socket for angled work.

With compact design.



UJ40

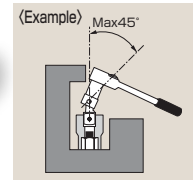

## UNIVERSAL JOINT

Models	Square Drive (mm)	Dimensions (mm)				Qty./Carton		Weight (g)
		D <sub>1</sub>	D <sub>2</sub>	L <sub>1</sub>	L	(Generally)	(Store Center)	
<b>308</b>	12.7	25	25	15.5	70.5	10	6	145

- ★ Require stock availability.

- Swing angle : In left and right, 75 degree



### CAUTION

- Joints consist of a convex drive and a concave drive and parts between them, and the torque. Do not handle the tool roughly as it might weaken torque transmission efficiency and impact torque. Both JIS and ISO standards are about half the strength of the ratchet handle.

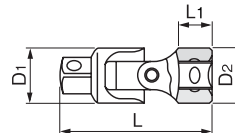

Universal joint, which is most suitable for working on limited space.

Connecting it between a handle and socket for angled work.



308

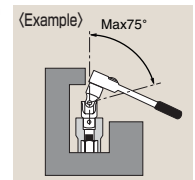

## SOCKET ADAPTOR

Models	Square Drive (mm)	Dimensions (mm)			Qty./Carton		Weight (g)
		D	L <sub>1</sub>	L	(Generally)	(Store Center)	
※1 <b>68</b>	12.7 Concave x 9.5 Convex	22	17	31.6	10	6	50
<b>128</b>	12.7 Concave x 19.0 Convex	25	17	42.0	10	6	115



### CAUTION

- Do not apply excessive force in case of adaptor (※1) having large concave sq. drive, as convex sq. drive might be broken.
- Limit-torque of adaptor is based in smaller sq. drive.

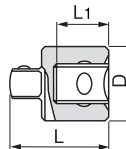

Used to change drive size.



68



128

## CROSS BAR

Models	Dimensions (mm)		Qty./Carton		Weight (g)
	D	L	(Generally)	(Store Center)	
<b>110</b>	12	250	10	6	225

- ★ Require stock availability.



Use spinner handle as a T-type handle with crossbar.



110



### CAUTION

- Do not use with power tools.
- Do not assemble multiple attachments. (Extension bar, Universal joint, Socket adaptor, Quick adaptor)