

## IMPACT BALL JOINT

Models	Square Drive (mm)	Dimensions (mm)				Qty./Carton		Weight (g)
		D <sub>1</sub>	D <sub>2</sub>	L <sub>1</sub>	L	(Generally)	(Store Center)	
<b>NJ40</b>	12.7	34	25	17	85.5	5	6	280

- Swing angle : About 20 degree



- ※ This product is patent registered.
- ※ In case of out-of-stock, the impact socket will be automatically changed to double-grooved type.

### Pin/O-ring compatible chart

Models <b>NJ</b>	<b>40</b>
Pin	P3020S
O-ring	RP20S

- ※ Within a plastic bag (10 pcs./pkg.)

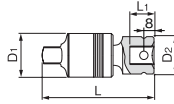

Angled work is possible with a connection between the socket and handle.  
Suitable for working on complicated space.  
Appearance and anti-rust upgraded with electroless nickel plating.



Model change



NJ40

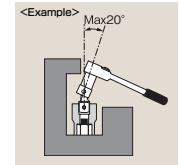

## IMPACT BALL JOINT, SHORT TYPE

Models	Square Drive (mm)	Dimensions (mm)				Qty./Carton		Weight (g)
		D <sub>1</sub>	D <sub>2</sub>	L <sub>1</sub>	L	(Generally)	(Store Center)	
<b>NJ40S</b>	12.7	33.5	25	17	63	5	6	180

- Swing angle : About 30 degree



- ※ This product is patent registered.
- ※ In case of out-of-stock, the impact socket will be automatically changed to double-grooved type.

### Pin/O-ring compatible chart

Models <b>NJ</b>	<b>40S</b>
Pin	P3020S
O-ring	RP20S

- ※ Within a plastic bag (10 pcs./pkg.)

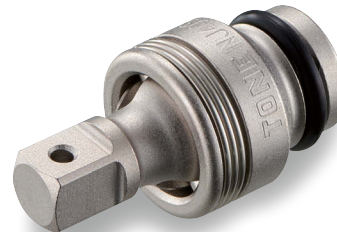
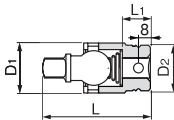

NJ40S

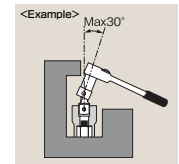

### Repair kit

Models **RK-NJ40** **NEW**



### Repair kit

Models **RK-NJ40S** **NEW**



## IMPACT SOCKET ADAPTOR

Models	Square Drive (mm)	Dimensions (mm)			Qty./Carton		Weight (g)
		D	L <sub>1</sub>	L	(Generally)	(Store Center)	
※1 <b>NA43</b>	12.7 Concave×9.5 Convex	25	17	33	5	6	80
<b>NA46</b>	12.7 Concave×19.0 Convex	25	17	42	5	6	110



- ※ This product is patent registered.
- ※ In case of out-of-stock, the impact socket will be automatically changed to double-grooved type.

### Pin/O-ring compatible chart

Models <b>NA</b>	<b>43, 46</b>
Pin	P3020S
O-ring	RP20S

- ※ Within a plastic bag (10 pcs./pkg.)

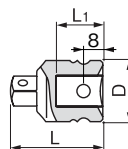

Used to change drive size.  
Electroless nickel plating.  
Better appearance and anti-rust.



NA43



NA46

### CAUTION

- Do not apply excessive force in case of adaptor (※1) having large concave sq. drive, as convex sq. drive might be broken.
- Limit-torque of adaptor is based on smaller sq. drive.
- Do not assemble multiple attachments. (Extension bar, Universal joint, Socket adaptor, Quick adaptor)



For impact wrenches

### WARNING

- Use right size o-ring and pin securely fixed.
- O-ring and pin are consumptive parts. Replace those which are deteriorated or worn.