

RATCHET RING WRENCH, LONG, FLEX HEAD SET

Models **RMA300L**

Contents **3 Items**

Models	RMA-	10L	12L	14L
Across Flat(mm)		10	12	14

- Tool Bag (BNRM2X)
- Weight : 0.62kg • Qty./Carton : 1

※ A tool bag is available for separate purchase. Please see P115.

Models **RMA400L**

Contents **4 Items**

Models	RMA-	10L	12L	14L	17L
Across Flat(mm)		10	12	14	17

- Tool Bag (BNRM2X)
- Weight : 0.97kg • Qty./Carton : 1

※ A tool bag is available for separate purchase. Please see P115.

Easy to store and carry!!



NEW

Great for tightening work in confined spaces. Improve work efficiency by using ring part for strong force, and ratchet ring part for fast turning. Since both heads are offset on one side, it can also be used for bolts/nuts in the counter bore.

Good Design award winning item

Extra long flex-head ratchet type



RMA300L



RMA400L

Example



RATCHET RING WRENCH, LONG, FLEX HEAD

Models	Across Flat (mm)	Dimensions (mm)					Qty./ Carton (Generally)	Weight (g)
		D ₁	D ₂	T ₁	T ₂	L		
RMA-08L	8	13.2	16.4	7.5	12.0	285	10	88
RMA-10L	10	15.7	20.0	8.5	12.8	315	10	124
RMA-12L	12	19.2	23.0	9.5	14.7	350	10	175
RMA-13L	13	19.3	25.0	10.5	15.6	380	10	213
RMA-14L	14	21.8	27.0	11.5	16.5	405	10	263
RMA-17L	17	25.9	31.6	13.5	18.8	435	10	357
RMA-19L	19	27.8	33.7	14.5	19.7	460	5	420

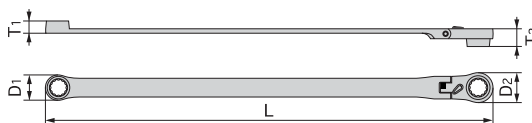

Good Design award



RMA-13L

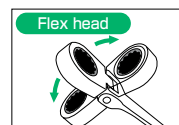

Flex head

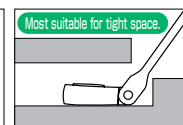

Most suitable for tight space.



Offset on both head.
Possible to apply on bolt/nut even with counterbore!

CAUTION

- Due to the long length, output torque tends to be high even if applied torque is low. Do not apply excessive force when tightening bolts.
- Switch over the direction completely.

REPAIR KIT for RATCHET RING WRENCH, LONG, FLEX HEAD

Models	Suitable model
RK-RMA08	RMA-08L
RK-RMA10	RMA-10L
RK-RMA12	RMA-12L
RK-RMA13	RMA-13L
RK-RMA14	RMA-14L
RK-RMA17	RMA-17L
RK-RMA19	RMA-19L

Above repair kit consists of NO.1- 3 from Parts table.

CAUTION

- Difficult to repair by oneself.

A set for exchanging ratchet flex head.

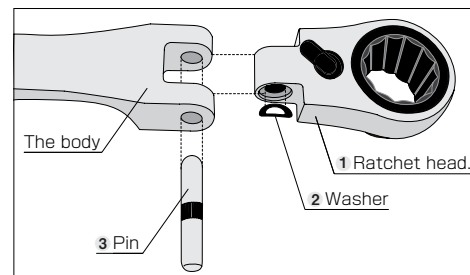

Parts table

NO.	Descriptions	Qty.
1	Ratchet head	1
2	Washer	1
3	Pin	1

CAUTION

- Use wrench suitably fitted with bolt / nut.
- Do not use with extension pipe etc.
- Avoid giving shock by hitting with hammer etc.